

BASE FILLERS

3", 6" wide base cabinet filler.
Finish one face and one long edge.

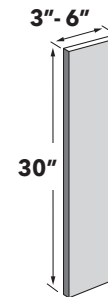

ITEM	DESCRIPTION	PRICE GROUP									
		01	02	03	04	05	06	07	08	09	10
BF3	Base Filler, 3 X 30 X 3/4	\$42	\$43	\$46	\$49	\$61	\$55	\$49	\$49	\$108	\$119
BF6	Base Filler, 6 X 30 X 3/4	\$70	\$72	\$78	\$83	\$104	\$94	\$83	\$83	\$179	\$198

VANITY BASE FILLERS

3", 6" wide base cabinet filler.
Finish one face and one long edge.

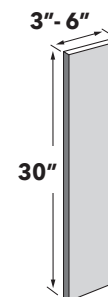

ITEM	DESCRIPTION	PRICE GROUP									
		01	02	03	04	05	06	07	08	09	10
VF3	Vanity Filler, 3 X 30 X 3/4	\$42	\$43	\$46	\$49	\$61	\$55	\$49	\$49	\$108	\$119
VF6	Vanity Filler, 6 X 30 X 3/4	\$70	\$72	\$78	\$83	\$104	\$94	\$83	\$83	\$215	\$238

WALL FILLERS

3" - 6" wide filler for 30" - 42" high wall cabinet.
Finish one face and one long edge.

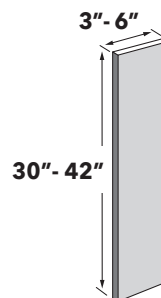

ITEM	DESCRIPTION	PRICE GROUP									
		01	02	03	04	05	06	07	08	09	10
WF330	Wall Filler, 3 X 30 X 3/4	\$42	\$43	\$46	\$49	\$61	\$55	\$49	\$49	\$108	\$119
WF336	Wall Filler, 3 X 36 X 3/4	\$50	\$51	\$55	\$59	\$74	\$66	\$59	\$59	\$129	\$143
WF339	Wall Filler, 3 X 39 X 3/4	\$54	\$56	\$60	\$64	\$80	\$72	\$64	\$64	\$140	\$155
WF342	Wall Filler, 3 X 42 X 3/4	\$58	\$60	\$64	\$69	\$86	\$78	\$69	\$69	\$151	\$167
WF630	Wall Filler, 6 X 30 X 3/4	\$70	\$72	\$78	\$83	\$104	\$94	\$83	\$83	\$179	\$198
WF636	Wall Filler, 6 X 36 X 3/4	\$84	\$87	\$93	\$100	\$124	\$113	\$100	\$100	\$215	\$238
WF639	Wall Filler, 6 X 39 X 3/4	\$91	\$94	\$101	\$108	\$135	\$122	\$108	\$108	\$233	\$258
WF642	Wall Filler, 6 X 42 X 3/4	\$99	\$101	\$109	\$116	\$145	\$131	\$116	\$116	\$251	\$278

TALL FILLERS

3", 6" wide tall cabinet filler.
Finish one face and one long edge.

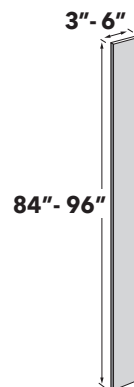

ITEM	DESCRIPTION	PRICE GROUP									
		01	02	03	04	05	06	07	08	09	10
TF384	Tall Filler, 3 X 84 X 3/4	\$99	\$101	\$109	\$116	\$145	\$131	\$116	\$116	\$251	\$278
TF390	Tall Filler, 3 X 90 X 3/4	\$106	\$109	\$116	\$124	\$156	\$141	\$124	\$124	\$269	\$297
TF393	Tall Filler, 3 X 93 X 3/4	\$109	\$112	\$120	\$129	\$161	\$145	\$129	\$129	\$278	\$307
TF396	Tall Filler, 3 X 96 X 3/4	\$113	\$116	\$124	\$133	\$166	\$150	\$133	\$133	\$287	\$317
TF684	Tall Filler, 6 X 84 X 3/4	\$179	\$184	\$197	\$211	\$264	\$239	\$211	\$211	\$402	\$444
TF690	Tall Filler, 6 X 90 X 3/4	\$192	\$198	\$211	\$226	\$283	\$256	\$226	\$226	\$430	\$476
TF693	Tall Filler, 6 X 93 X 3/4	\$198	\$204	\$219	\$234	\$292	\$264	\$234	\$234	\$445	\$492
TF696	Tall Filler, 6 X 96 X 3/4	\$205	\$211	\$226	\$241	\$302	\$273	\$241	\$241	\$459	\$508

BASE FILLER OVERLAY

2 7/8", 5 7/8" wide base filler overlay.

Finished 1 face and all 4 edges.

Minimum width for custom sizes is 2 7/8".

2 7/8" - 5 7/8"

29 7/8"

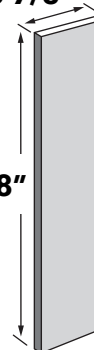

ITEM	DESCRIPTION	PRICE GROUP									
		01	02	03	04	05	06	07	08	09	10
BFO3	Base Overlay Filler, 2 7/8 X 29 7/8 X 3/4	\$50	\$51	\$55	\$59	\$74	\$66	\$59	\$59	\$129	\$156
BFO6	Base Overlay Filler, 5 7/8 X 29 7/8 X 3/4	\$84	\$87	\$93	\$100	\$124	\$113	\$100	\$100	\$259	\$312

VANITY BASE FILLER OVERLAY

2 7/8", 5 7/8" wide base filler overlay.

Finished 1 face and all 4 edges.

Minimum width for custom sizes is 2 7/8".

2 7/8" - 5 7/8"

29 7/8"

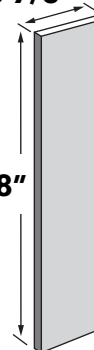

ITEM	DESCRIPTION	PRICE GROUP									
		01	02	03	04	05	06	07	08	09	10
VFO3	Vanity Overlay Filler, 2 7/8 X 29 7/8 X 3/4	\$50	\$51	\$55	\$59	\$74	\$66	\$59	\$59	\$129	\$156
VFO6	Vanity Overlay Filler, 5 7/8 X 29 7/8 X 3/4	\$84	\$87	\$93	\$100	\$124	\$113	\$100	\$100	\$259	\$312

WALL OVERLAY FILLERS

2 7/8", 5 7/8" wide wall filler overlay

Finished 1 face and all 4 edges.

Minimum width for custom sizes is 2 7/8".

2 7/8" - 5 7/8"

29 7/8"
41 7/8"

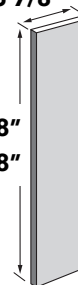

ITEM	DESCRIPTION	PRICE GROUP									
		01	02	03	04	05	06	07	08	09	10
WFO330	Wall Overlay Filler, 2 7/8 X 29 7/8 X 3/4	\$50	\$51	\$55	\$59	\$74	\$66	\$59	\$59	\$129	\$156
WFO336	Wall Overlay Filler, 2 7/8 X 35 7/8 X 3/4	\$60	\$62	\$66	\$71	\$88	\$80	\$71	\$71	\$155	\$187
WFO339	Wall Overlay Filler, 2 7/8 X 38 7/8 X 3/4	\$65	\$67	\$72	\$77	\$96	\$86	\$77	\$77	\$168	\$203
WFO342	Wall Overlay Filler, 2 7/8 X 41 7/8 X 3/4	\$70	\$72	\$77	\$82	\$103	\$93	\$82	\$82	\$181	\$219
WFO630	Wall Overlay Filler, 5 7/8 X 29 7/8 X 3/4	\$84	\$87	\$93	\$100	\$124	\$113	\$100	\$100	\$216	\$260
WFO636	Wall Overlay Filler, 5 7/8 X 35 7/8 X 3/4	\$101	\$104	\$112	\$119	\$149	\$135	\$119	\$119	\$259	\$312
WFO639	Wall Overlay Filler, 5 7/8 X 38 7/8 X 3/4	\$110	\$113	\$121	\$129	\$162	\$146	\$129	\$129	\$281	\$338
WFO642	Wall Overlay Filler, 5 7/8 X 41 7/8 X 3/4	\$118	\$122	\$130	\$139	\$174	\$158	\$139	\$139	\$302	\$364

TALL OVERLAY FILLERS

2 7/8", 5 7/8" wide tall filler overlay.

Finished 1 face and all 4 edges.

Minimum width for custom sizes is 2 7/8".

2 7/8" - 5 7/8"

79 1/2"
91 1/2"



ITEM	DESCRIPTION	PRICE GROUP									
		01	02	03	04	05	06	07	08	09	10
TFO384	Tall Overlay Filler, 2 7/8 X 79 1/2 X 3/4	\$118	\$122	\$130	\$139	\$174	\$158	\$139	\$139	\$272	\$328
TFO390	Tall Overlay Filler, 2 7/8 X 85 1/2 X 3/4	\$127	\$130	\$140	\$149	\$187	\$169	\$149	\$149	\$291	\$351
TFO393	Tall Overlay Filler, 2 7/8 X 88 1/2 X 3/4	\$131	\$135	\$144	\$154	\$193	\$174	\$154	\$154	\$301	\$363
TFO396	Tall Overlay Filler, 2 7/8 X 91 1/2 X 3/4	\$135	\$139	\$149	\$159	\$199	\$180	\$159	\$159	\$311	\$375
TFO684	Tall Overlay Filler, 5 7/8 X 79 1/2 X 3/4	\$215	\$221	\$237	\$253	\$317	\$286	\$253	\$253	\$423	\$583
TFO690	Tall Overlay Filler, 5 7/8 X 85 1/2 X 3/4	\$230	\$237	\$254	\$272	\$339	\$307	\$272	\$272	\$453	\$546
TFO693	Tall Overlay Filler, 5 7/8 X 88 1/2 X 3/4	\$238	\$245	\$262	\$281	\$351	\$317	\$281	\$281	\$468	\$564
TFO696	Tall Overlay Filler, 5 7/8 X 91 1/2 X 3/4	\$246	\$253	\$271	\$290	\$362	\$327	\$290	\$290	\$483	\$583

BASE & VANITY DECORATIVE END

20 7/8" - 23 7/8" wide decorative end. Finished end should be added if using decorative ends.

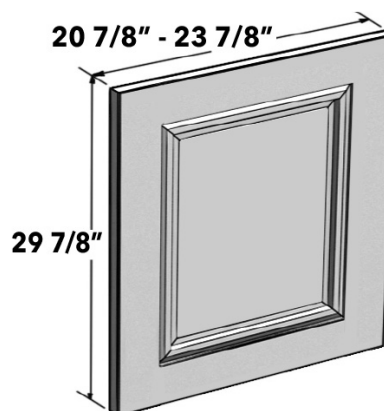

ITEM	DESCRIPTION	PRICE GROUP									
		01	02	03	04	05	06	07	08	09	10
BDE24	Base Decorative End, 23 7/8 X 29 7/8 X 3/4	\$183	\$188	\$194	\$215	\$222	\$194	\$304	\$311	\$518	\$624
VBDE21	Vanity Decorative End, 20 7/8 X 29 7/8 X 3/4	\$160	\$165	\$170	\$188	\$194	\$170	\$266	\$272	\$453	\$546

WALL DECORATIVE END

11 7/8" - 41 7/8" high wall decorative end. Finished end should be added if using decorative ends.

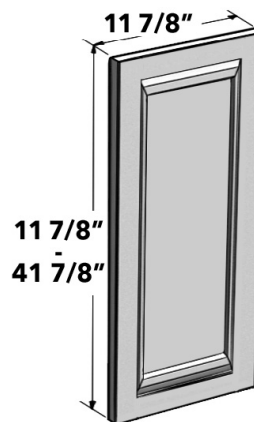

ITEM	DESCRIPTION	PRICE GROUP									
		01	02	03	04	05	06	07	08	09	10
WDE12	Wall Decorative End, 11 7/8 X 11 7/8 X 3/4	\$49	\$50	\$52	\$57	\$59	\$52	\$81	\$83	\$138	\$166
WDE15	Wall Decorative End, 11 7/8 X 14 7/8 X 3/4	\$61	\$63	\$65	\$72	\$74	\$65	\$101	\$104	\$173	\$208
WDE18	Wall Decorative End, 11 7/8 X 17 7/8 X 3/4	\$73	\$75	\$78	\$86	\$89	\$78	\$122	\$124	\$207	\$250
WDE21	Wall Decorative End, 11 7/8 X 20 7/8 X 3/4	\$85	\$88	\$91	\$100	\$103	\$91	\$142	\$145	\$242	\$291
WDE24	Wall Decorative End, 11 7/8 X 23 7/8 X 3/4	\$90	\$93	\$96	\$106	\$109	\$96	\$150	\$153	\$256	\$308
WDE30	Wall Decorative End, 11 7/8 X 29 7/8 X 3/4	\$91	\$94	\$97	\$108	\$111	\$97	\$152	\$155	\$259	\$312
WDE36	Wall Decorative End, 11 7/8 X 35 7/8 X 3/4	\$110	\$113	\$116	\$129	\$133	\$117	\$182	\$186	\$311	\$375
WDE39	Wall Decorative End, 11 7/8 X 38 7/8 X 3/4	\$119	\$122	\$126	\$140	\$144	\$126	\$197	\$202	\$337	\$406
WDE42	Wall Decorative End, 11 7/8 X 41 7/8 X 3/4	\$128	\$132	\$136	\$151	\$155	\$136	\$213	\$217	\$363	\$437

TALL DECORATIVE END LOWER

Decorative end (bottom door of tall unit). Finished end should be added if using decorative ends.

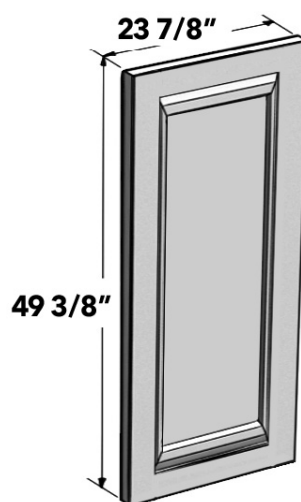

ITEM	DESCRIPTION	PRICE GROUP									
		01	02	03	04	05	06	07	08	09	10
TDE49	Tall Decorative End Lower, 23 7/8 X 49 3/8 X 3/4	\$302	\$311	\$320	\$355	\$366	\$321	\$501	\$512	\$855	\$1,030

TALL DECORATIVE END UPPER

Decorative end (top door of tall unit). Finished end should be added if using decorative ends.

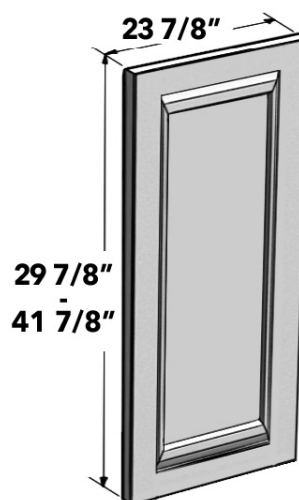

ITEM	DESCRIPTION	PRICE GROUP									
		01	02	03	04	05	06	07	08	09	10
TDEU30	Tall Decorative End Upper, 23 7/8 X 29 7/8 X 3/4	\$183	\$188	\$194	\$215	\$222	\$194	\$304	\$311	\$518	\$624
TDEU36	Tall Decorative End Upper, 23 7/8 X 35 7/8 X 3/4	\$220	\$226	\$233	\$258	\$266	\$233	\$365	\$373	\$622	\$749
TDEU39	Tall Decorative End Upper, 23 7/8 X 38 7/8 X 3/4	\$238	\$245	\$252	\$280	\$288	\$253	\$395	\$404	\$673	\$812
TDEU42	Tall Decorative End Upper, 23 7/8 X 41 7/8 X 3/4	\$256	\$264	\$272	\$301	\$310	\$272	\$425	\$435	\$725	\$874

BASE & VANITY GABLE END PANEL

21 7/8" - 24 7/8" wide gable end panel.
Reduced height and width modifications
available at no charge.

All 4 edges are finished.

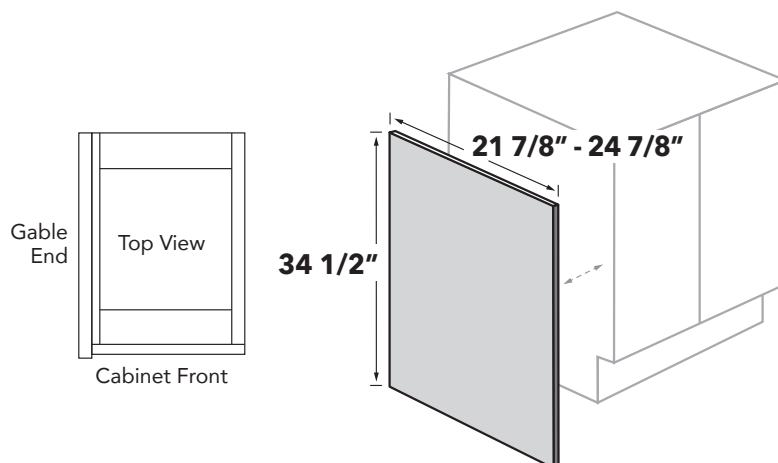

ITEM	DESCRIPTION	PRICE GROUP									
		01	02	03	04	05	06	07	08	09	10
BGE24	Base Gable End Panel, 24 7/8 X 34 1/2 X 3/4	\$219	\$226	\$233	\$258	\$266	\$233	\$258	\$258	\$621	\$748
VBGE21	Vanity Gable End Panel 21 7/8 X 34 1/2 X 3/4	\$193	\$199	\$205	\$227	\$234	\$205	\$227	\$227	\$547	\$659

WALL GABLE END PANEL

12 7/8" wide gable end panel.
Reduced height and width modifications
available at no charge.

All 4 edges are finished.

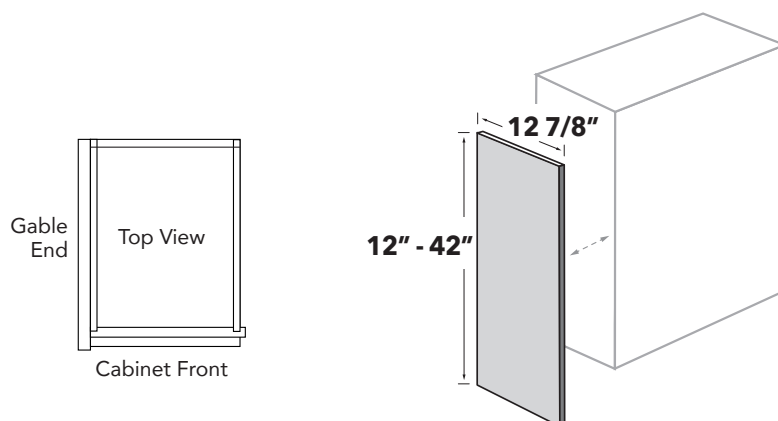

ITEM	DESCRIPTION	PRICE GROUP									
		01	02	03	04	05	06	07	08	09	10
WGE12	Wall Gable End Panel, 12 7/8 X 12 X 3/4	\$53	\$54	\$56	\$62	\$64	\$56	\$62	\$62	\$150	\$180
WGE15	Wall Gable End Panel 12 7/8 X 15 X 3/4	\$66	\$68	\$70	\$77	\$80	\$70	\$77	\$77	\$186	\$225
WGE18	Wall Gable End Panel, 12 7/8 X 18 X 3/4	\$79	\$82	\$84	\$93	\$96	\$84	\$93	\$93	\$224	\$271
WGE21	Wall Gable End Panel, 12 7/8 X 21 X 3/4	\$93	\$95	\$98	\$109	\$112	\$98	\$109	\$109	\$262	\$316
WGE24	Wall Gable End Panel, 12 7/8 X 24 X 3/4	\$98	\$101	\$104	\$115	\$119	\$104	\$115	\$115	\$277	\$334
WGE30	Wall Gable End Panel, 12 7/8 X 30 X 3/4	\$99	\$102	\$105	\$117	\$120	\$105	\$117	\$117	\$281	\$338
WGE36	Wall Gable End Panel, 12 7/8 X 36 X 3/4	\$119	\$122	\$126	\$140	\$144	\$126	\$140	\$140	\$337	\$406
WGE39	Wall Gable End Panel, 12 7/8 X 39 X 3/4	\$129	\$133	\$137	\$152	\$156	\$137	\$152	\$152	\$365	\$440
WGE42	Wall Gable End Panel, 12 7/8 X 42 X 3/4	\$139	\$143	\$147	\$163	\$168	\$147	\$163	\$163	\$393	\$473

TALL GABLE END PANEL

54" - 96" high gable end panel.
Reduced height and width modifications
available at no charge.

All 4 edges are finished.

*Use TGE54 with TGEU30-42 for 2 piece look
for Shaker styles for tall utility/pantry.

*Use TGE84, TGE90, TGE93, TGE96 for full
height tall door gable ends for tall utility/pantry.

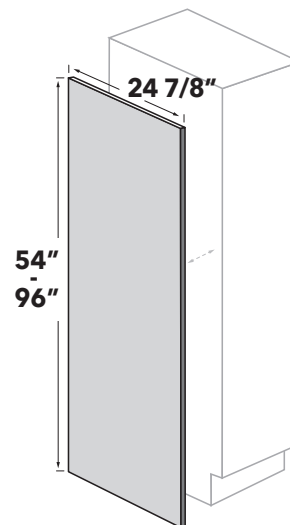
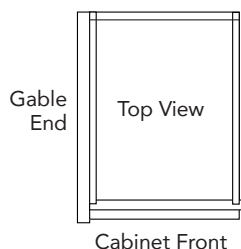

ITEM	DESCRIPTION	PRICE GROUP									
		01	02	03	04	05	06	07	08	09	10
TGE54	Tall Gable End Panel, 24 7/8 X 53 3/4 X 3/4	\$343	\$353	\$364	\$404	\$416	\$364	\$404	\$404	\$971	\$1,171
TGE84	Tall Gable End Panel, 24 7/8 X 84 X 3/4	\$534	\$550	\$566	\$628	\$647	\$567	\$628	\$628	\$1,511	\$1,821
TGE90	Tall Gable End Panel, 24 7/8 X 90 X 3/4	\$572	\$589	\$606	\$673	\$693	\$607	\$673	\$673	\$1,619	\$1,951
TGE93	Tall Gable End Panel, 24 7/8 X 93 X 3/4	\$591	\$608	\$627	\$695	\$716	\$628	\$695	\$695	\$1,673	\$2,016
TGE96	Tall Gable End Panel, 24 7/8 X 96 X 3/4	\$610	\$628	\$647	\$717	\$739	\$648	\$717	\$717	\$1,726	\$2,080

TALL GABLE END PANEL

30" - 42" high gable end panel.
Reduced height and width modifications
available at no charge.

All 4 edges are finished.

*Use with TGE54 for 2 piece look for
Shaker styles for tall utility/pantry.

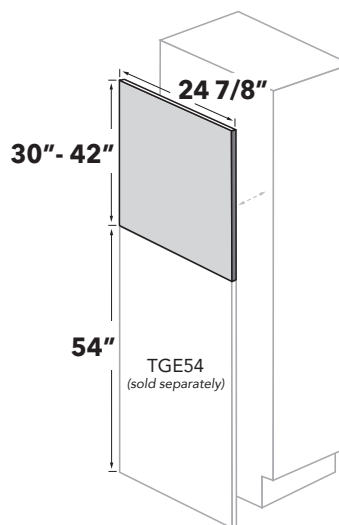
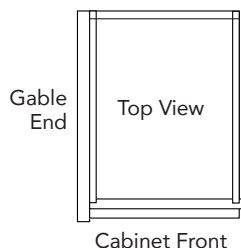

ITEM	DESCRIPTION	PRICE GROUP									
		01	02	03	04	05	06	07	08	09	10
TGEU30	Tall Gable End Panel, 24 7/8 X 30 X 3/4	\$191	\$196	\$202	\$224	\$231	\$203	\$224	\$224	\$540	\$651
TGEU36	Tall Gable End Panel, 24 7/8 X 36 X 3/4	\$229	\$236	\$243	\$269	\$277	\$243	\$269	\$269	\$647	\$780
TGEU39	Tall Gable End Panel, 24 7/8 X 39 X 3/4	\$248	\$255	\$263	\$291	\$300	\$263	\$291	\$291	\$701	\$845
TGEU42	Tall Gable End Panel, 24 7/8 X 42 X 3/4	\$267	\$275	\$283	\$314	\$323	\$283	\$314	\$314	\$755	\$910

ISLAND BACK PANEL

Island back panel. Finished one face and one long edge. All 3/4" panel core in MDF and Furniture Board material only.



ITEM	DESCRIPTION	PRICE GROUP									
		01	02	03	04	05	06	07	08	09	10
FP3496	Island Back Panel, 34 1/2 X 96 X 3/4	\$557	\$574	\$591	\$655	\$675	\$591	\$655	\$655	\$1,979	\$2,189

ISLAND BACK PANEL, CROSS GRAIN

Island back panel. Finished one face and one long edge. All 3/4" panel core in MDF and Furniture Board material only.

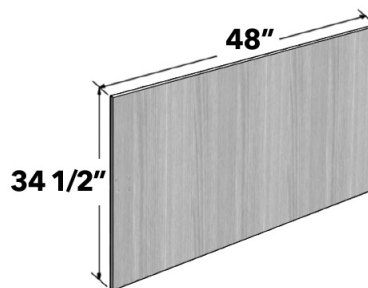

ITEM	DESCRIPTION	PRICE GROUP									
		01	02	03	04	05	06	07	08	09	10
FP4834	Island Back Panel, 48 X 34 1/2 X 3/4 Cross Grain	\$279	\$287	\$296	\$328	\$338	\$296	\$328	\$328	\$989	\$1,094

ISLAND BACK PANEL

Island back panel 1/4" & 3/4" thick.
Finished one face.

1/4" panel (FS4896) not available in Milan
Gloss in Electra Series.

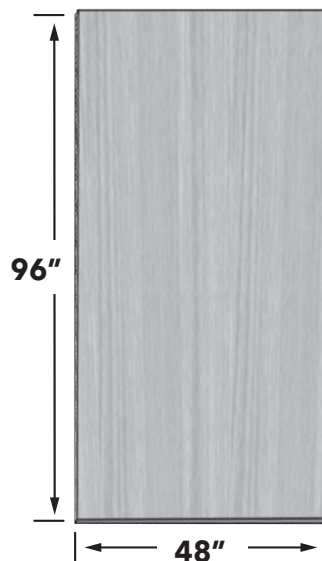

ITEM	DESCRIPTION	PRICE GROUP									
		01	02	03	04	05	06	07	08	09	10
FS4896	Island Back Panel, 48 X 96 X 1/4	\$540	\$557	\$573	\$636	\$655	\$573	\$636	\$636	N/A	N/A
FP4896	Island Back Panel, 48 X 96 X 3/4	\$581	\$599	\$617	\$684	\$704	\$617	\$912	\$912	N/A	N/A

REFRIGERATOR PANEL

Refrigerator panel finished both faces.
Finished one long edge. 3/4" panel available in
matching color on both sides in the Electra Series.

Milan Gloss in Electra Series will have backs of panels in
NON-gloss, but in a similar color tone.

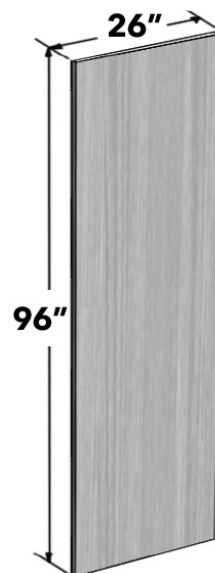

ITEM	DESCRIPTION	PRICE GROUP									
		01	02	03	04	05	06	07	08	09	10
RP2696	Refrigerator Panel, 26 X 96 X 3/4	\$518	\$533	\$549	\$941	\$969	\$549	\$941	\$941	\$1,796	\$2,165

VANITY DESK DRAWER RETURN PANEL

24" trimmable base panel. Finished both faces.
Finished one long edge. 3/4" panel available
in matching color on both sides in the Electra Series.

Milan Gloss in Electra Series will have backs of panels
in NON-gloss, but in a similar color tone.

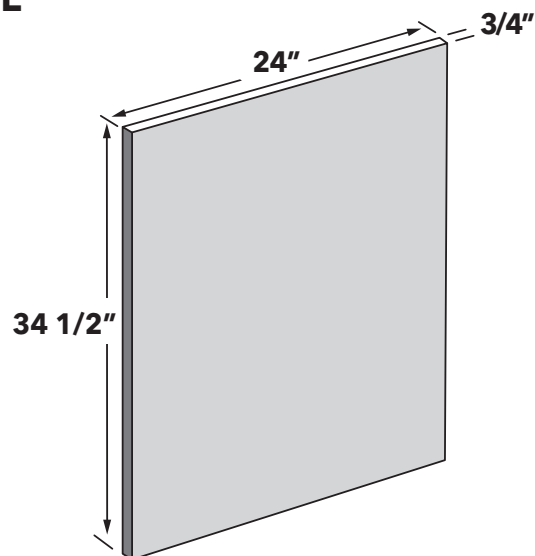

ITEM	DESCRIPTION	PRICE GROUP									
		01	02	03	04	05	06	07	08	09	10
VDDRP34	Vanity Desk Drawer Return Panel, 24 X 34 1/2 X 3/4	\$172	\$177	\$182	\$312	\$321	\$182	\$312	\$312	\$596	\$718

DISHWASHER PANEL

1 1/2" dishwasher panel.

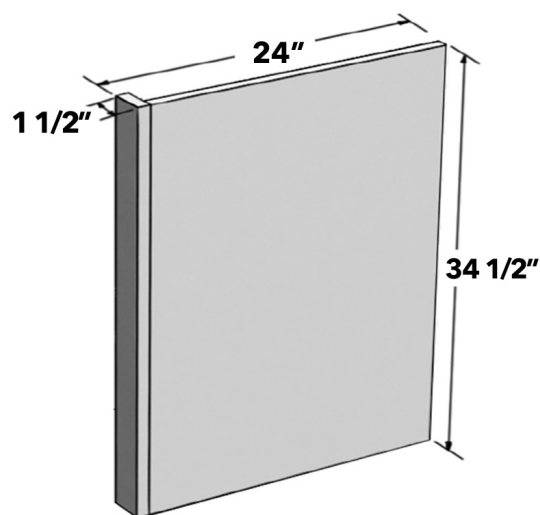

ITEM	DESCRIPTION	PRICE GROUP									
		01	02	03	04	05	06	07	08	09	10
DWEP1 1/2	Dishwasher Panel, 24 X 34 1/2 X 1 1/2	\$212	\$218	\$225	\$249	\$257	\$225	\$249	\$249	\$602	\$666

DISHWASHER PANEL

3" dishwasher panel.

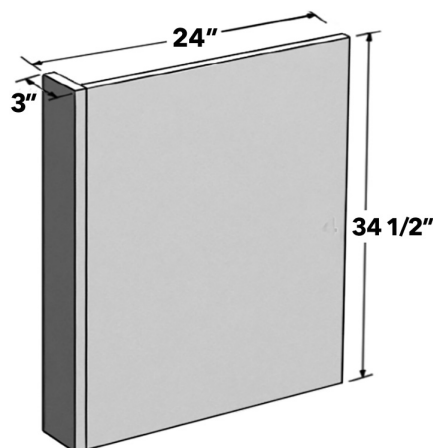

ITEM	DESCRIPTION	PRICE GROUP									
		01	02	03	04	05	06	07	08	09	10
DWEP3	Dishwasher Panel, 24 X 34 1/2 X 3	\$242	\$249	\$257	\$285	\$293	\$257	\$285	\$285	\$688	\$761

FLOATING SHELVES

- Standard height is 2".
- Standard depth is 10".
- Available in 1/16" width increments from 24" to 72".
- Standard grain direction will be horizontal on top, bottom, and front edge. Ends will have vertical grain.
- Option of horizontal grain top, bottom, and all edges.
- Metal brackets are included with your order.
Max load weight for included bracket is 10 lbs per lineal foot.

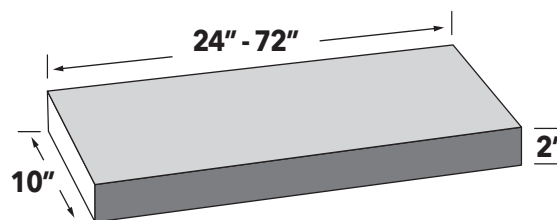

NOTE: All laminate and melamine products will show a fine black edge where the face material meets the side material. More noticeable on white or lighter finishes.

FSHF2-48. Specify width on excel order form notes or in 2020.
(i.e. FSHF2-48-43.5 = Floating Shelf, 43.5" x 2" x 10")

ITEM	DESCRIPTION	PRICE GROUP									
		01	02	03	04	05	06	07	08	09	10
FSHF2-36	Floating Shelf, 24" - 36"	\$632	\$632	\$632	\$632	\$632	\$632	\$632	\$632	\$755	\$843
FSHF2-48	Floating Shelf, 36 1/16" - 48"	\$842	\$842	\$842	\$842	\$842	\$842	\$842	\$842	\$1007	\$1123
FSHF2-60	Floating Shelf, 48 1/16" - 60"	\$993	\$993	\$993	\$993	\$993	\$993	\$993	\$993	\$1186	\$1324
FSHF2-72	Floating Shelf, 60 1/16" - 72"	\$1192	\$1192	\$1192	\$1192	\$1192	\$1192	\$1192	\$1192	\$1423	\$1589

SHELF MATERIAL

3/4" thick shelf material. Available interior box material or finished material. Must specify.

NOTE: to calculate exact width and depth to fit inside a cabinet:

Take outside cabinet width and subtract 1 5/8"

Take outside cabinet depth and subtract 1"

Example: extra shelf for W3630 = 34 3/8" x 11"

Order by exact size. Priced by the square foot.

Width x Depth divided by 144 = square feet.

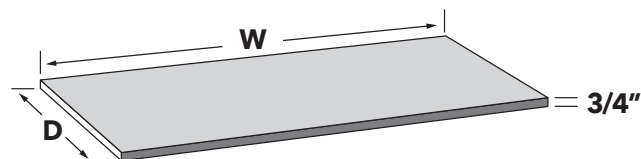

NOTE: If there is a grain pattern, it will run the direction of the width dimension.

One edge of the width will be edge banded.

SHELF-W. Specify width and depth on excel order form notes or in 2020. Excel will calculate square footage. (i.e. enter in Excel as: Shelf-W-34.375-11 = White melamine shelf, 34.375" x 11" x 3/4".

ITEM	DESCRIPTION	PRICE PER SQ. FT.
SHELF-W	White Melamine	\$13
SHELF-G	Gray Melamine	\$15
SHELF-B	Birch Plywood	\$18
SHELF-L	Matches Laminate, Foil, Melamine, Paints	\$45
SHELF-V	Matches Veneer Door	\$97

CUSTOM SIZED DOORS

Available in "Electra Series" only. Minimum 2 square foot charge.

All four edges of panels will be edge banded.

- Roma Series will have matching backs where available per door styling description.
- Roma Shaker Series will have a minimum of 6" width and height for profile details.
- Minimum width and height for Slab Doors is 3".

Order by exact size. Priced by the square foot.

Width x Height divided by 144 = square feet.

Example: 12" x 38" = 456 divided by 144 = 3.167 square feet.

(i.e. enter in Excel as: FASCIA-L-12-38 =

Laminate, Foil, Lacquer Door 12" x 38" x 3/4").

Excel will calculate square footage.

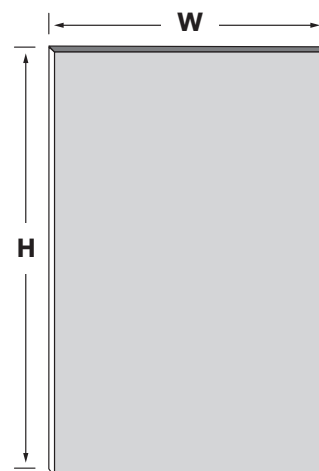

ITEM	DESCRIPTION	PRICE PER SQ. FT.
FASCIA-L	Laminate, Foil, Melamine, Lacquer Doors	\$73
FASCIA-V	Veneer Doors	\$129